

STEP 4-4 Tail Output Shaft Assembly

Sub Assembly 4 Tail Boom

Slide one M5x11 Ball Bearing onto each end of the Tail Rotor Drive Shaft assembly and insert through the inside of the right side of the Tail Rotor Gearbox Housing. Make sure the bearing is fully seated into the recess. Slide the tail rotor pitch plate assembly onto the shaft.

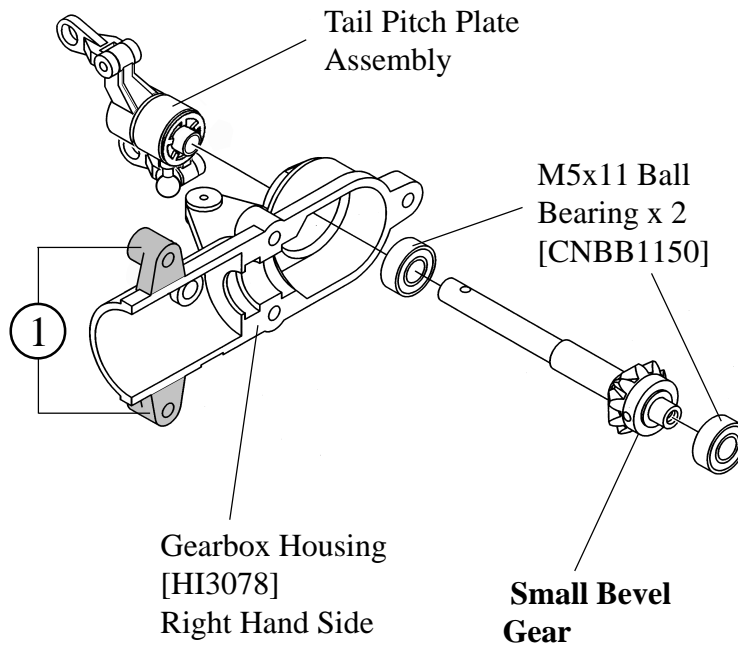

When replacing the tail gearbox, the two fin mounts (1) shaded in grey, need to be trimmed off as these fuselages uses the adjustable clamp to secure the tailboom.

Agusta 109
Airwolf
Bell222
Long Ranger
Twinstar

STEP 4-5 Tail Rotor Hub

From parts bag 7: Install the Tail Rotor Hub onto the tail rotor drive shaft, (**position the hub so the hole is aligned over the partial hole in the shaft**). Using threadlock, insert and secure the M3x4 Set Screw. Insert one M3x16 Socket Cap Screw through one M3x10 Ball Bearing (**apply the threadlock to the threads in the hub to avoid getting threadlock in the bearings**), and attach to the hub assembly, using threadlock. Repeat for the other side.

