

## STEP 3-2 Upper Frame Assembly

## Sub Assembly 3 Main Mechanics

From parts bag 2: Insert the two long Hex Spacers at the specified locations in the diagram. **Note: the front hex spacer is installed into the forward-most hole.** Install the upper left side frame, taking care that the bearings are aligned with the mating recesses and secure the frames with four M3x35 Socket Cap Screws (*do not use threadlock when using locknuts*) through the main shaft bearing block positions and four M3 locknuts. It is advised to position the elevator assembly between the side frames at this time in order to reduce the amount of re-positioning later.

While pulling up on the main shaft (make sure the main gear rotates freely), push the mast stopper against the upper ball bearing insuring that the raised inner portion of the stopper is facing upwards. Temporarily tighten one M4x5 set screw and remove the other, apply threadlock and tighten in place. Repeat for the first set screw to apply threadlock and tighten. Attach the remaining four M3x12 Self Tapping Screws (*see Tip 3 at the bottom of Step 3-1*) to the starting shaft blocks.

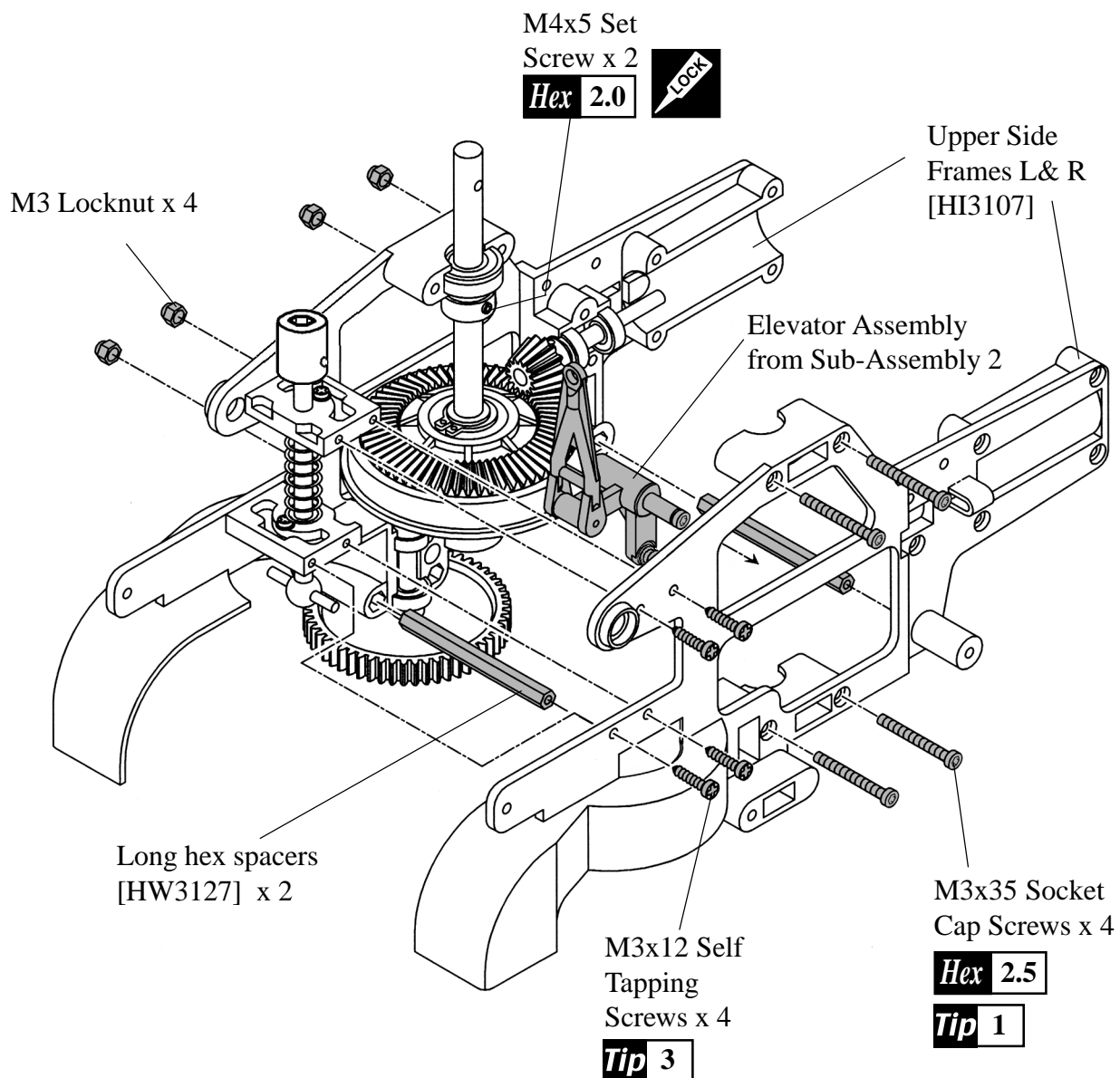

The gear mesh between the main gear and the tail transmission output shaft may be a snug fit at first, but it will become smooth after a few flights. This is the normal wear in process. Do not lubricate any of these gears.