

### STEP 3-1 Upper Side Frames

### Sub Assembly 3 Main Mechanics

From parts bag 2: Install two M4x5 Set Screws (*note-do not apply loctite at this time*) into the Mast Stopper (**note that the raise inner diameter must face the ball bearing**) and slide the mast stopper on the main shaft followed by one M10x19 Ball Bearing and one 14x19 Spacer (the spacer must be installed on top of the bearing). Slide one M8x19 Ball Bearing from the bottom of the main shaft.

Attach the starter shaft assembly to the side upper side frame with four M3x12 Self Tapping Screws (**observe the correct orientation of the block assemblies**). Position the main gear/main shaft assembly, (**note the orientation of the mast stopper, the raised inner diameter should be facing upward, towards the inner race of the top bearing**) the counter gear assembly and the tail transmission output shaft assembly in the designated locations (see diagram below) on the upper right side frame (**Make sure the bearings are fully seated in the recesses.**)

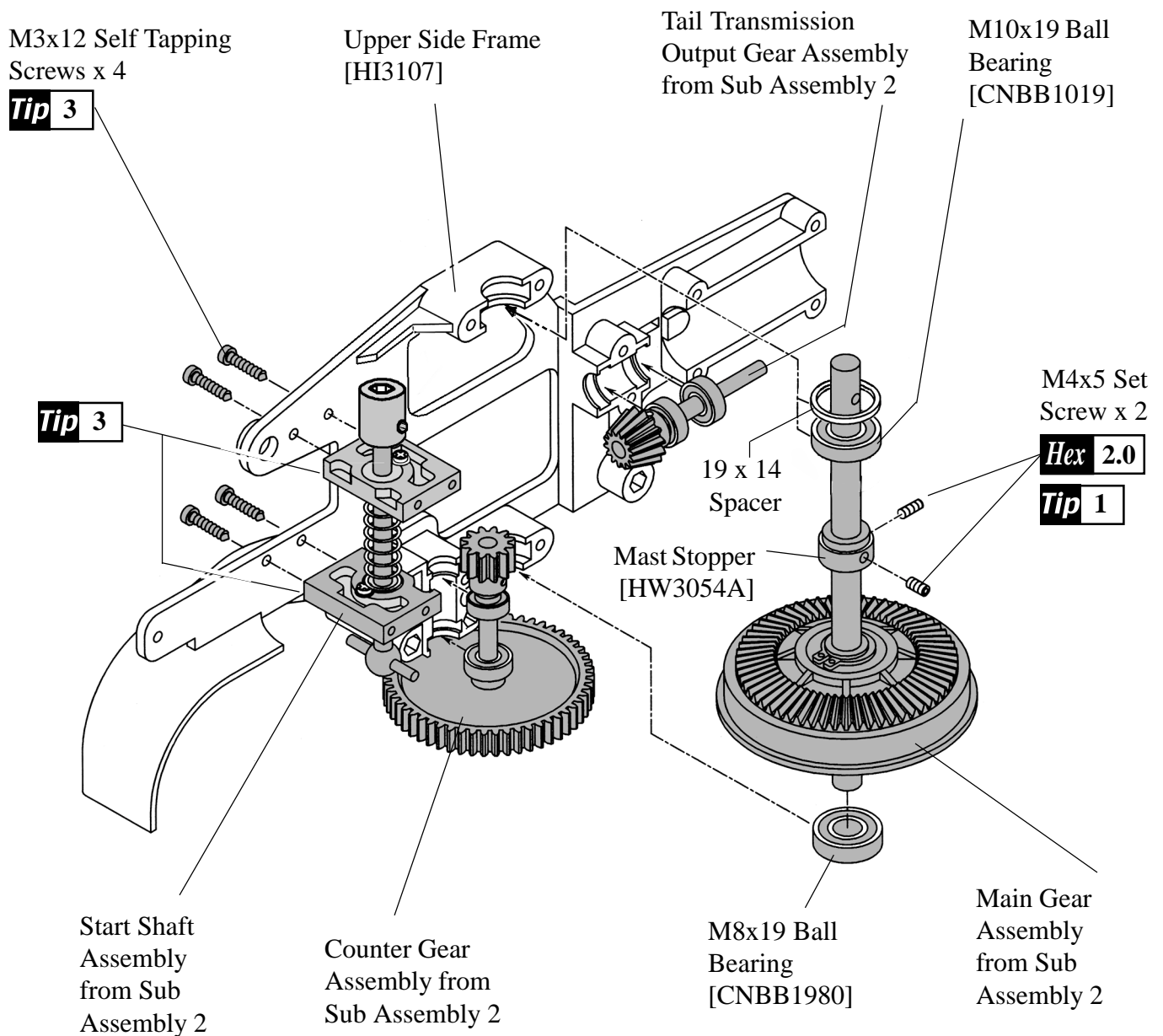

**Tip 3** Be careful when tightening the eight M3x12 self tapping screws into the start shaft block assemblies as excessive force can strip the plastic holes.