

STEP 2-5 Main Gear & Shaft Assembly

Sub Assembly 2 Main Gear Train

From parts bag 2: The Main Gear is pre-assembled with the Auto-Rotation Bearing installed. Insert the bottom end of the main shaft through the auto rotation gear assembly, align the holes and secure the Main Shaft using one M3x16 Socket Cap Screw and one M3 Locknut.

Tip You can temporarily insert the mast stopper, upper main shaft bearing, main bearing spacer, and head block screw to keep them from getting lost! * **Do not apply threadlock now!**



At some time in the future you will need to change the main gear. The main gear assembly can be taken out of the mechanics by removing only the main shaft and tilt the main gear angled higher at the front and slide out of the upper side frames. When removing the auto-rotation bearing, note that it **must** be re-installed into the new gear in the same direction, otherwise when power is applied the gear will not drive the main shaft, only the gear will turn.

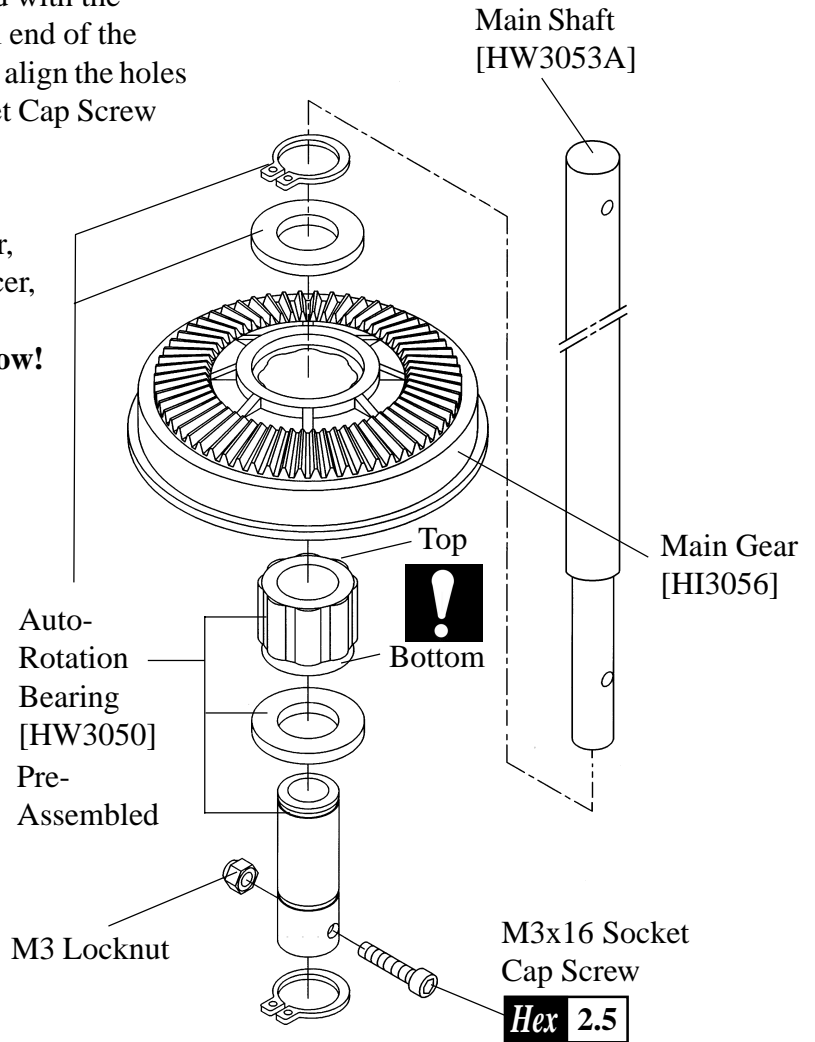

STEP 2-6 Elevator Lever

From parts bag 2: Insert the long threaded axle and one M3x7 ball bearing from each end of the bellcrank. Slide one short spacer over one M3x30 Socket Cap screw and attach to the threaded axle (**do not use threadlock here!**), repeat for other side. The M2x16 pin is assembled, just insure the elevator radius link moves freely against the Bellcrank. Thread one short black ball into the elevator arm.



CNQSC04
Optional machined ball bearing elevator arm w/ adjustable ball link.

