

STEP 2-1 Start Shaft Bearing Blocks

From parts bag 2: the Start Shaft Guide Blocks are pre-assembled. Slide the Starter Shaft through one of the block assemblies with the M5x11 Ball Bearing facing up and slide the spring and 5mm washer and M5 Collar onto the shaft.

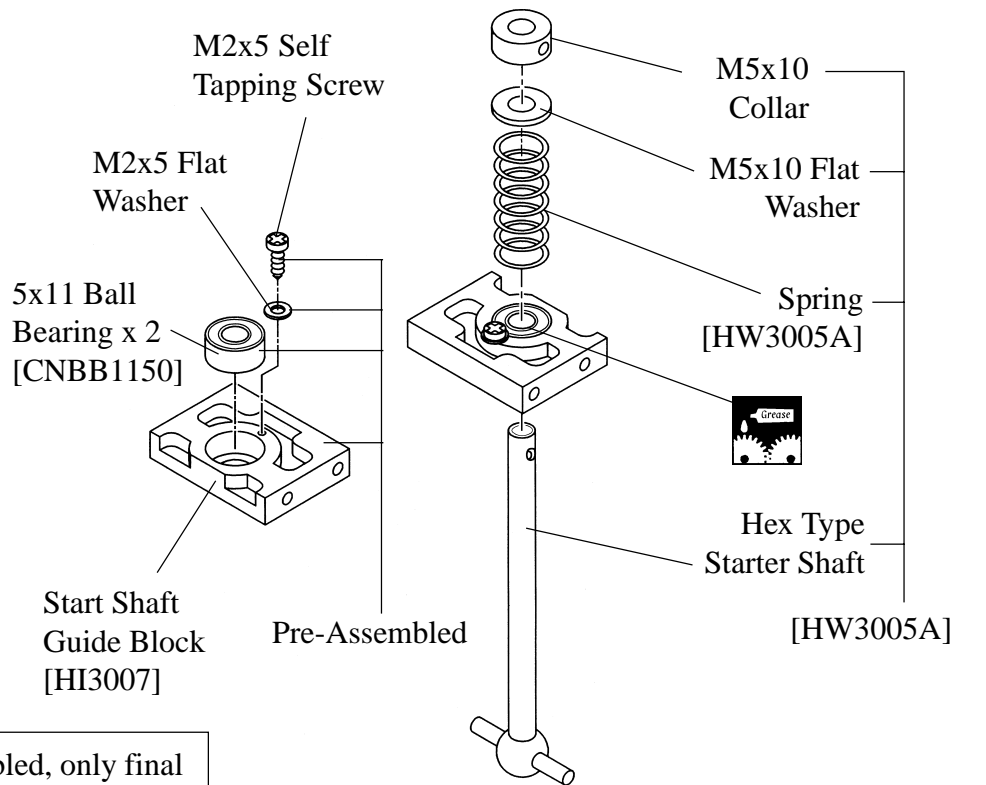

Guide blocks are pre-assembled, only final assembly is needed.

STEP 2-2 Engine Start Shaft

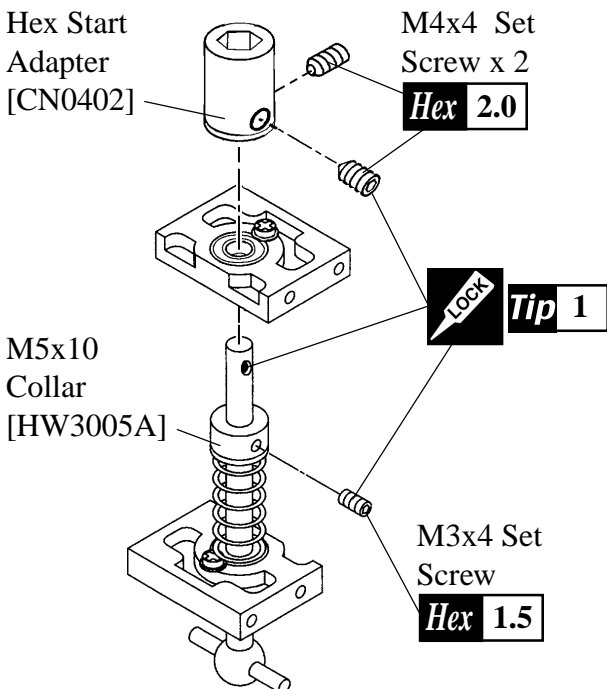

From parts in bag 2: Slide the M5x10 Collar spaced approximately 29mm from the top of the start shaft and partially tighten with one M3x4 Set Screw followed by the second bearing block. Next apply threadlock from the top of the shaft to just past the indent and slide the Hex Coupler to align over the indent in the shaft. Secure with two M4x4 set screws aligning one to the indent, using threadlock. Apply some lubricant on the shaft after assembly to ensure smooth vertical movement inside the inner races of the bearings when engaging and disengaging of the start system.

When removing the hex start wand (not included in kit) after the engine is started, it is recommended that you follow this two step procedure.



#1: Lift the hex wand upwards just enough to disengage the start shaft from the fan while keeping the wand inserted in the hex coupler (CN0402)

#2: After the coupler has stopped turning, then remove the wand completely.