

Read This First!

Micro Scale Electric Helicopters

Detail Manual



CN1021 Airwolf ARF



CN1022 Bell 222 ARF



CN1023 Jet Ranger ARF



CN1024 BK117 ARF

FEATURES

- ⇒ **INCLUDES THE HUMMINGBIRD II MECHANICS**
- ⇒ **DURABLE, LIGHTWEIGHT FUSELAGE**
- ⇒ **EASY TO REMOVE FOR MAINTENANCE**
- ⇒ **AWESOME VISIBILITY IN FLIGHT**
- ⇒ **MOTOR SIZE** 280 - 370
- ⇒ **MAIN ROTOR DIAMETER** 508mm
- ⇒ **LENGTH** 485-500mm
- ⇒ **WEIGHT** 283-300g

Century Helicopter Products

Designed and Developed in USA

1st Edition November, 2003 All rights reserved.

These instructions cover the Bell222, Airwolf, Jet Ranger and the BK117 scale helicopters. Throughout the manual we only show the Bell222 photos but the process is the same for all scale helicopters.

STEP 1 Disassemble the fuselage.

Carefully remove the adhesive tape on the bottom of the fuselage, along the tail boom including the tape on the end of the fuselage tail boom end cap.

Remove:
High Gloss 1/4" Tape

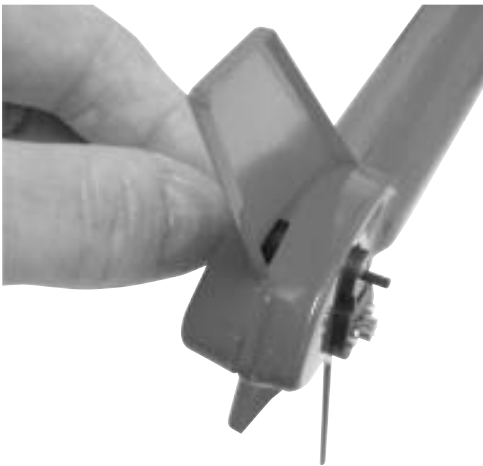
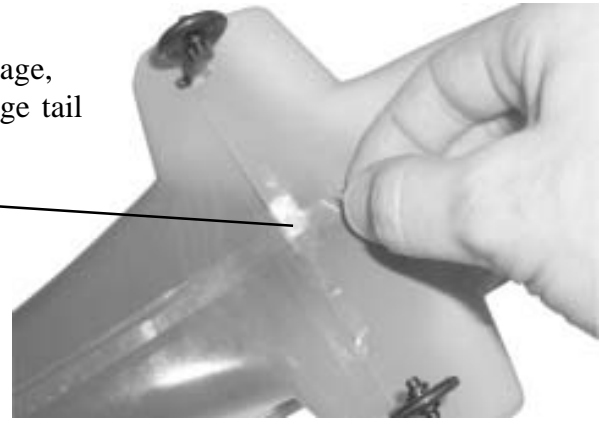

STEP 2 Disassemble the tail rotor.

Carefully remove the silicone rubber stopper from the end of the tail output shaft. Slide the tail rotor blades and the gear off the shaft and finally slide the tail output shaft out from the other side. Temporary reassemble the output shaft to avoid losing parts.

STEP 3 Disconnect the rotor head pushrods.

Very carefully disconnect the pushrods from the balls on the upper swashplate ring. It is best to use a set of needle nose pliers and gently press the center ball away from the link. Notice the pushrod starting to come off and press the link off with your fingers.



Remove:
M1x10 Steel Pin

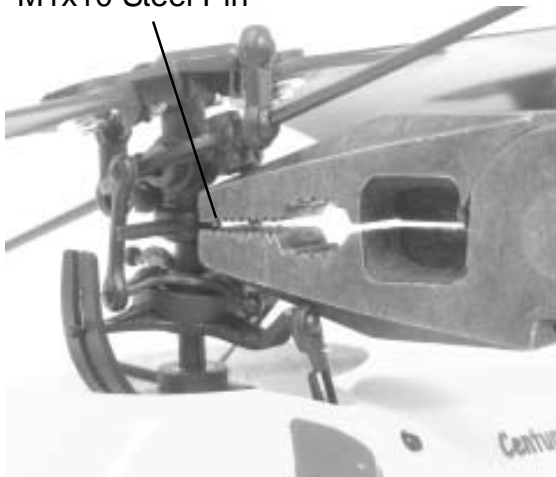

STEP 4 Remove the rotor head.

Firmly hold the rotor head in one hand as you press one end of the pin flush to the rotor hub using the end of a set of pliers. Now the pin will be exposed enough to be able to grab with pliers and carefully remove. Be very careful when using pliers close to the rotor head to avoid damaging any other parts. Insert two fingers to hold the main gear from turning and gently twist the main rotor head while pulling outward to remove it from the main shaft.

STEP 5 Remove the mechanics.

Slide the upper fuselage mount post out from one side (1) while holding the rotor head. Carefully remove one vertical stab from one end of the horizontal fin. Keep the double sided tape clean to be able to re-attach it later. Gently pull the horizontal fin out (2) from the tail boom of the fuselage. Starting at the tail motor, gently open the bottom of the tail boom halves (3) to release the tail boom. Continue spreading the bottom of the fuselage as you work towards the front. Be especially careful at the landing gear/wheels (4) to avoid ripping the bottom fuselage material and remove the entire mechanics.

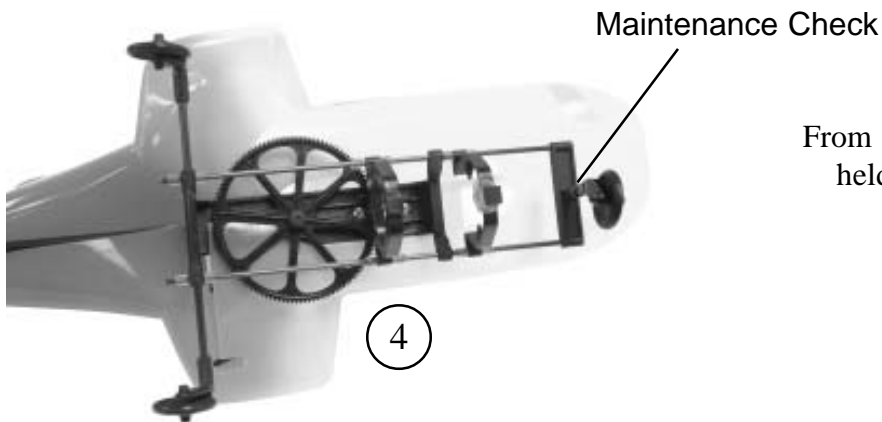
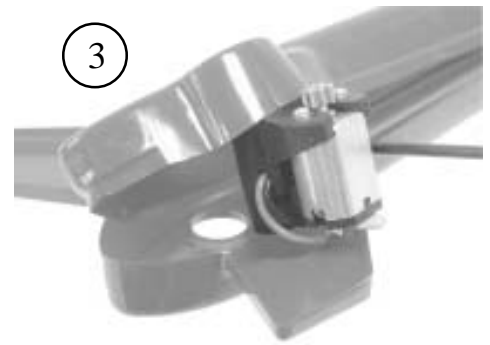
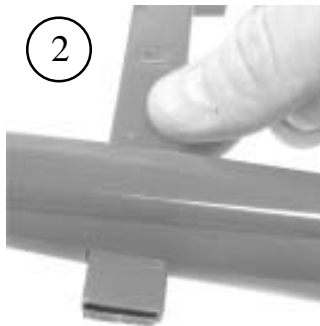

Bell 222 & Airwolf Landing Gear

From time to time check the front wheel as it is held in place with one silicon rubber stopper that can loosen over time.



STEP 5-1 Removing the Step (BK117)

It is not necessary to remove the pilot steps when removing the BK117 fuselage. Just carefully flex the body until the mechanics drop out the bottom.

STEP 6 Installing the radio equipment.

Having removed the fuselage, follow the assembly information in the regular Hummingbird manual to install the servos, receiver, gyro, control board, and battery. The helicopter should be test flown BEFORE it is installed into the fuselage and any trimming or balancing done now. Once the helicopter has been trimmed, it can be disassembled once more and installed into the fuselage.

STEP 7 Finishing the fuselage.

After the mechanics are installed the last few items to complete is to seal the bottom of the fuselage. DO NOT bond in place. Using 1/4" crystal clear adhesive tape (or 1/2" cut to 1/4" on glass) tape the two halves together along the seams. Do not use any type of cyanoacrylate (crazy glue) adhesive on the fuselage material. The vapor from cyanoacrylate type glues will permanently damage the material.

Bell 222 & Airwolf

Special note. During shipping it is possible for the rear wheels to become unglued from the landing gear. If this has happened to you, then simply bond the wheel back in place AFTER it has been removed from the fuselage using cyanoacrylate type of adhesive.

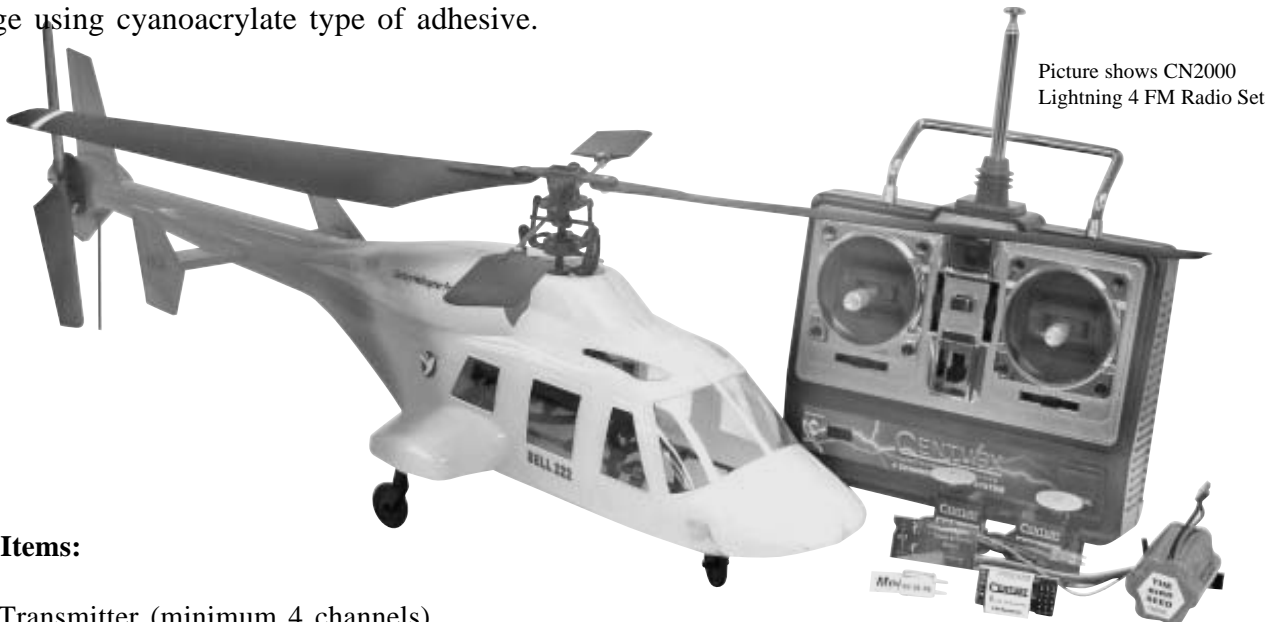

Necessary Items:

- | | |
|--|---------|
| 1 x Radio Transmitter (minimum 4 channels) | |
| 1 x Micro FM/PCM Receiver (minimum 4 channels) | CN2032 |
| 2 x Micro Servos | CN2023 |
| 1 x Micro Gyro | CN2022E |
| 1 x 8.4V 600mAh NiMH Battery | CNE050 |
| 1 x 8.4V NiMH Battery Charger | CNE051 |
| 1 x HummingBoard Mixer/Speed Control | CNE052 |

CN2000 Lightning 4 FM Radio Set

Includes:

- 72MHz Transmitter
- 72MHz FM Receiver (300M)
- Micro Servo x 2
- Gyro Mixer Board
- Tx & Rx Crystals

Transmitter requires 8 'AA' type batteries.

Full Kits, conversions and replacement parts

- | | | | |
|----------|--|---------|---|
| CN1021 | Hummingbird II Painted Airwolf Full Kit | CNE003A | Long Main Rotor Blades (2) |
| CN1021A | Painted Airwolf Conversion Kit | CNE022A | Long Tail Rotor Blade |
| CN1021-1 | Hummingbird II Airwolf Unpainted Full Kit | CNE056A | Gold Label HP370 Motor |
| CN1021-2 | Airwolf Unpainted Body Only | CNE014A | Airwolf & Bell 222 landing gear (includes wheels) |
| CN1021-3 | Tricycle Landing Gear for Airwolf & Bell222 | | |
| CN1022 | Hummingbird II Painted Bell 222 | | |
| CN1022A | Bell 222 Painted Conversion Kit | | |
| CN1022-1 | Hummingbird II Bell 222 Unpainted Full Kit | | |
| CN1022-2 | Bell 222 Unpainted Body Only | | |
| CN1023 | Hummingbird II Painted Jet Ranger Full Kit | | |
| CN1023A | Jet Ranger Painted Conversion Kit | | |
| CN1023-1 | Hummingbird II Jet Ranger Unpainted Full Kit | | |
| CN1024 | Hummingbird II Painted BK117 Full Kit | | |
| CN1024A | BK117 Painted Conversion Kit | | |
| CN1024-1 | Hummingbird II BK117 Unpainted Full Kit | | |

CENTURY

HELICOPTER PRODUCTS

1740 - C Junction Ave., San Jose, CA 95112
Fax: 408-451-1156 Web: www.centuryheli.com