

Step 39 Pushrod Setup and Adjustments

Make up all the control pushrods according to the specified lengths shown in the drawing. These are full scale drawings so you can easily match each pushrod to the page. Please note that the dimensions listed are from end to end of the plastic rod-ends. Fine tuning may be required as the picture size may change when printed. Note that some servos offer different horn placements for fine tuning and have different servo arm locations. The numbers in the center of the pushrod drawings are the actual length of the rods to help select the correct pushrod for each control surface.

After attaching the pushrods to the helicopter, the washout arms will be level at 0° collective for 3D flying. Beginners should follow the setup steps and pitch curves for Hovering in the final adjustments.

Note: It is very important that before you install the pushrod linkages that you first charge your radio then remove all the servo horns from the servos and center all the mechanical or electronic trims on the radio.



Measurements are tip to tip on the ball link.

1:1

All pushrods are shown full size.

Pushrod Set [HW3192] Ball Link Set [HI3145]

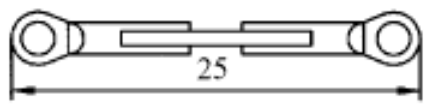

A (2) 54mm

Washout to Flybar Control Arm

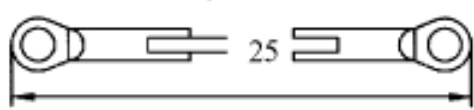

J (2) 61mm

Aileron Bellcrank to Swashplate

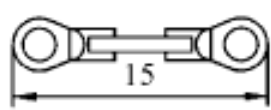

I (2) 33mm

Bell Mixer to Seesaw

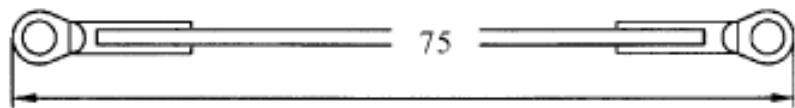

B (1) 103mm - 30SE

Throttle pushrod - 30SE

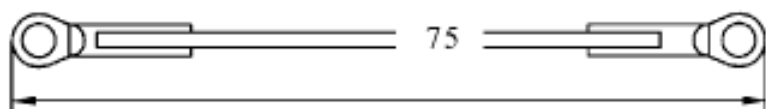

B (1) 100mm - 50SE

Throttle pushrod - 50SE

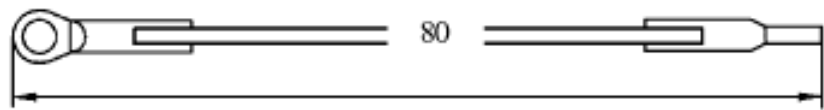

C (2) (Sport - 107mm)
(3D - 106mm)

Bell Mixer to Swashplate

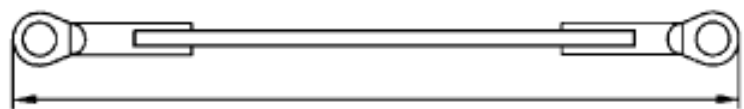

D (1) (Sport - 96mm)
(3D - 94mm)

Collective

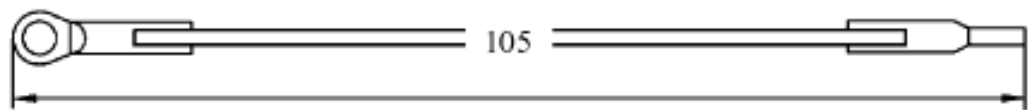

E (1) 134mm

Elevator pushrod

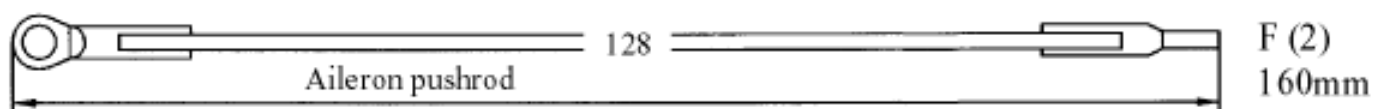

F (2) 160mm

Aileron pushrod



30 SE Tail Rotor pushrod [HW3064C]
50 SE Tail Rotor pushrod [HW3064D]