

Multi Bladed Rotor Head Systems

4 Bladed version shown in photos. Instructions apply to 3, 4 and 5 bladed versions.
CN1103, CN1104 & CN1105

Feathering Spindle Installation

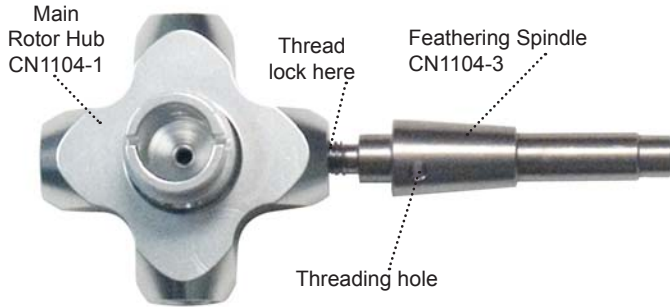

Attach the spindle to the center hub using a small drop of blue thread locking compound making sure to completely thread the spindle flush with the hub. A hex driver can be used in the threading hole to tighten. If one of the spindles are not flush with the main rotor hub the result will be an out of balance rotor head.

Attention: Always allow thread lock to set and dry over night in order to ensure that those assemblies are secure and are safe to fly.

Shims are provided and may be used between the thrust bearing and outer washer.

Main Blade Grips

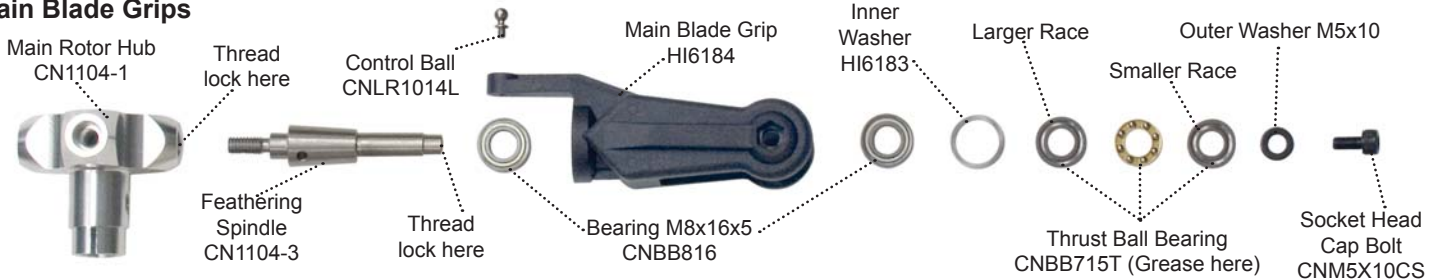

Assemble each main blade grip in the order depicted. Please note that the thrust bearing must be installed with the larger race inside toward the rotor hub. It is recommended to use a small amount of grease on the thrust ball bearings. Apply even pressure to the outer lip of the radial bearings to install. If the *plastic* blade grips are cold to the touch when installing the radial ball bearings they will be difficult to install. We suggest warming up the plastic blade grip before installing the ball bearings with a heat gun to allow the material to expand. Use a small drop of blue thread locking compound inside the female threaded portion on the spindle once comfortable with the order of assembly.

Attention: Do not use thread lock on ball bearings. Attempting to press the bearings into a cold plastic blade grip using a tool may potentially damage the ball bearings. Bearings are inspected prior to shipment for quality assurance and will not exhibit this damage if installed properly.

Metal Main Blade Grip

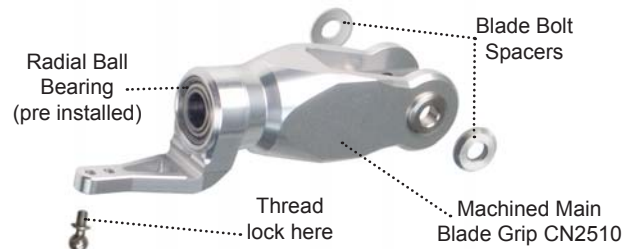

Attention: Metal blade grips have pre installed radial ball bearings. This is done at the factory. The metal blade grips in the fully metal version of the multi bladed rotor head system require the depicted blade bolt spacers for use with the blades and blade bolts included.

Main Shaft Sleeve & Collar

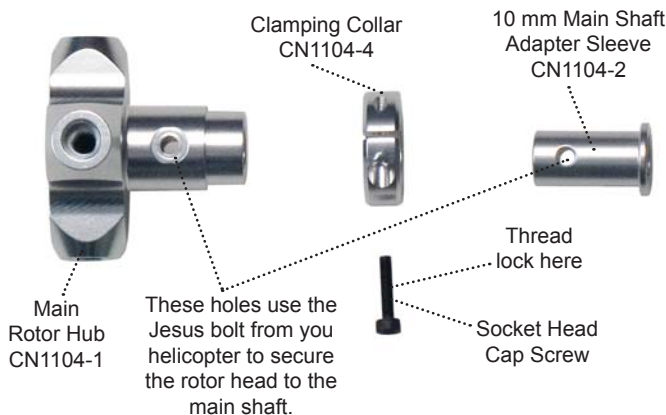

After the blade grips are installed a 10 mm shaft adapter sleeve and a clamping collar must be installed if using a helicopter with a 10 mm main shaft. Install the sleeve and the collar and slightly tighten the collar using the socket head cap screw provided. Only fully tighten the socket head cap screw when installing the new multi-blade rotor head assembly to the main shaft of the helicopter.



The completed rotor head should look similar to the above photo (depending on # of blades).

Replacement parts

CN1103-1	3 blade main rotor hub
CN1104-1	4 blade main rotor hub
CN1105-1	5 blade main rotor hub
CN1104-2	10mm main shaft sleeve (all)
CN1104-3	Multi blade feathering spindle (all)
CN1104-4	Main shaft clamping collar (all)
HI6184	Main blade grips (2)
CN2510	CNC Main blade grips with radial bearings (2)
CNBB816	M8x16x5 radial ball bearing (pre installed in CNC main blade grips)
CNBB715T	M7x15x5 thrust ball bearing
HI6183	Inner washer
CNM5x10FW	Outer washer
CNM5x10CS	M5x10 socket head cap bolt

Warranty Information

Your new multi rotor head system is warranted to the original purchaser against manufacturer defects in material and workmanship for one year from the date of purchase. During this period, Century Helicopter Products will repair or replace, at our discretion, any component that is found to be factory defective at no cost to the purchaser. This warranty is limited to the original purchaser and is not transferable. This warranty does not apply to any unit which has been improperly installed, mishandled, abused, or damaged in a crash, or to any unit which has been repaired or altered by any unauthorized agencies. Under no circumstances will the buyer be entitled to consequential or incidental damages. This limited warranty gives you specific legal rights. You also have other rights which may vary from state.



Century Helicopter Products
1740-C Junction Ave. San Jose, CA 95112
www.centuryheli.com