

STEP 7-8 Start Shaft

STEP 7

From parts bag 2, the Start Shaft Guide Blocks are pre-assembled. Slide the Starter Shaft through one of the block assemblies with the M5x11 Ball Bearing facing up and slide the spring and 5mm Washer onto the shaft.

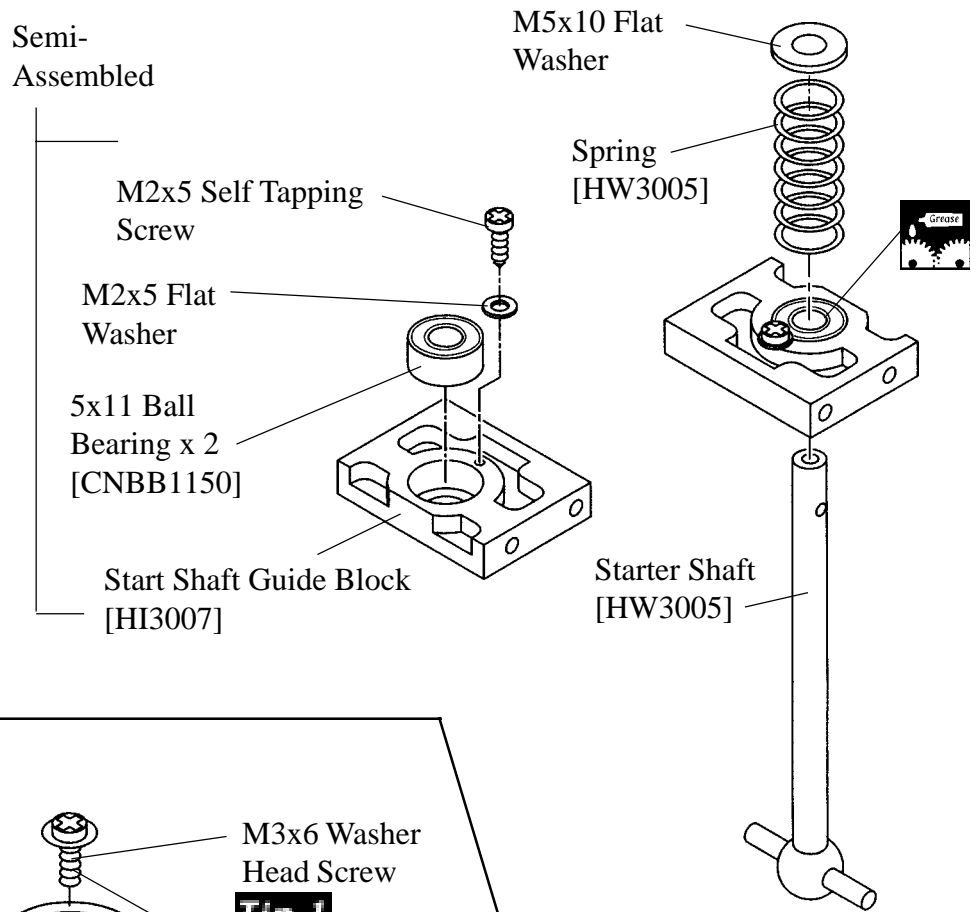

STEP 8

Optional:

Aluminum Start Cone #CN2209 & Hex Starting System #CN0427A
 Note: when using these systems, upgrade the starting shaft with the solid version, #CN2226.

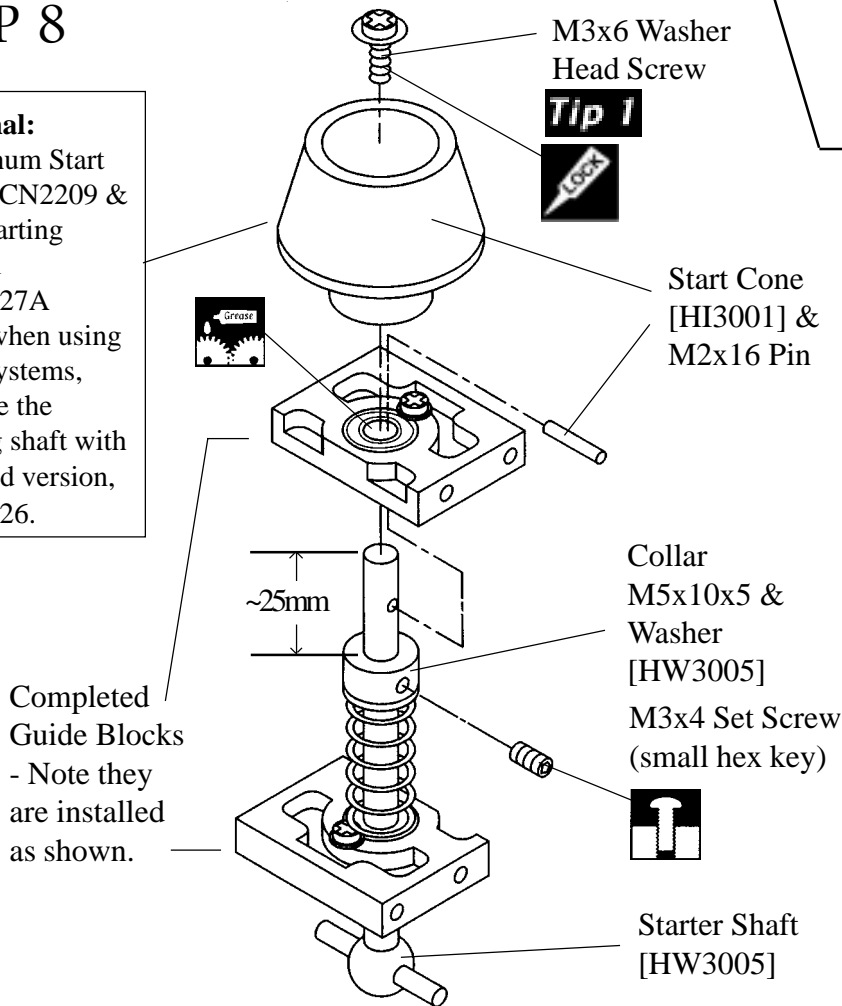

From parts in bag 2, slide the M5x10 Collar spaced approximately 25mm from the top of the start shaft and partially tighten with one M3x4 Set Screw. (After the engine assembly is installed the position on the start shaft will be adjusted to allow the starting shaft to disengage from the cooling fan.) Assemble the Starter Cone by installing the second Guide Block onto the start shaft, insert the pin through the hole in the top of the shaft and press the Start Cone over the pin, finally secure with one M3x6mm Washer Head Screw (**Tip 1**) from inside the cone using threadlock. Apply some lubricant on the shaft after assembly to ensure smooth operation.