

STEP 11-12 Auto Rotation, Main Gear & Elevator Bellcrank

STEP 11

The Main Gear is pre-assembled with the Auto-Rotation Bearing installed. From parts bag 2, the Main Shaft has two holes one farther from one end of the shaft, this end is the bottom of the shaft. Insert the bottom end through the auto rotation gear assembly aligning the holes and secure the Main Shaft using one 3x16mm Socket Cap Screw and one 3mm Locknut.

TIP 1 You can temporarily insert main shaft, main shaft bearing, stopper and head block screw, just keep for not lost! * Don't apply threadlock!

Completed Main Gear & Main Shaft

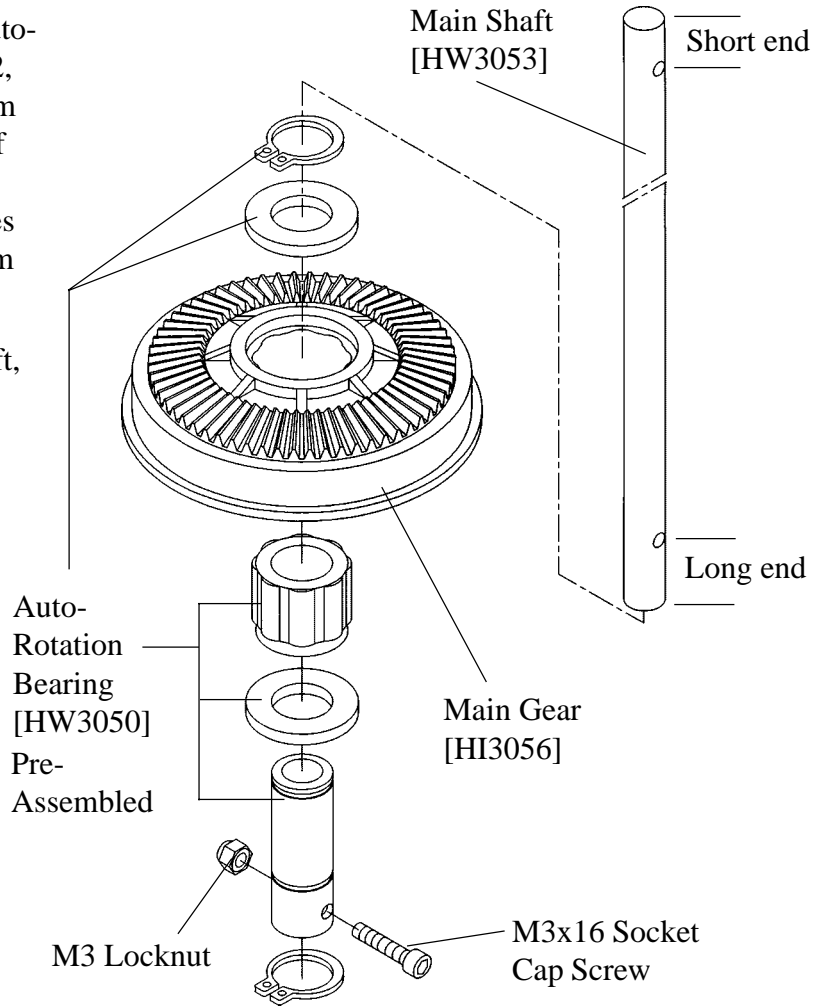
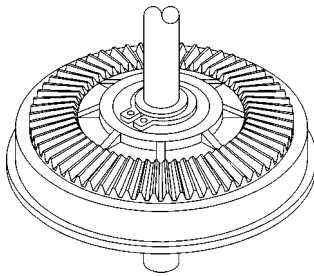

STEP 12

From parts bag 2, apply a small amount of lubricant to the long threaded axle and slide through the elevator bellcrank (semi-assembled), be careful not to get grease on the threads. Slide one short spacer over one 3x30mm Socket Cap screw and one 3x7mm washer, attach to the threaded axle (**do not use threadlock here!**), repeat for other side. The 2x16mm pin is assembled, just insure the elevator radius link moves freely against the Bellcrank. Thread one short black ball (m2 thread) into the elevator arm.



CNQSC04
Optional machined ball bearing elevator arm w/ adjustable ball link.

