

### STEP 33 Tail Drive Shaft Guides

From Bag 7: Insert three tail drive shaft Guides on to the Brass Tail Drive Housing, found in the bottom of the box (**Note that one guide has a larger center hole than the others, slide this one to the center of the brass tube** ) and add the remaining two onto the ends. Glue the guides into position using Zap Ca on the brass tube. Insert the new assembly into the tailboom from the end with the 2 holes and position the assembly centered in the tailboom ( **gentle tapping with a wooden dowel will easy the insertion of the guides** ). Secure inside the boom by dripping some Ca glue down the tube. Be careful not to get any between the wire drive and the tube. Slide the three tail pushrod guides onto the tailboom. From the rear, thread the long pushrod through the guides with the bent section at back. Screw the pushrod connector found in bag #4 onto the front of the long pushrod, the short pushrod will be attached to this later in Step 36.

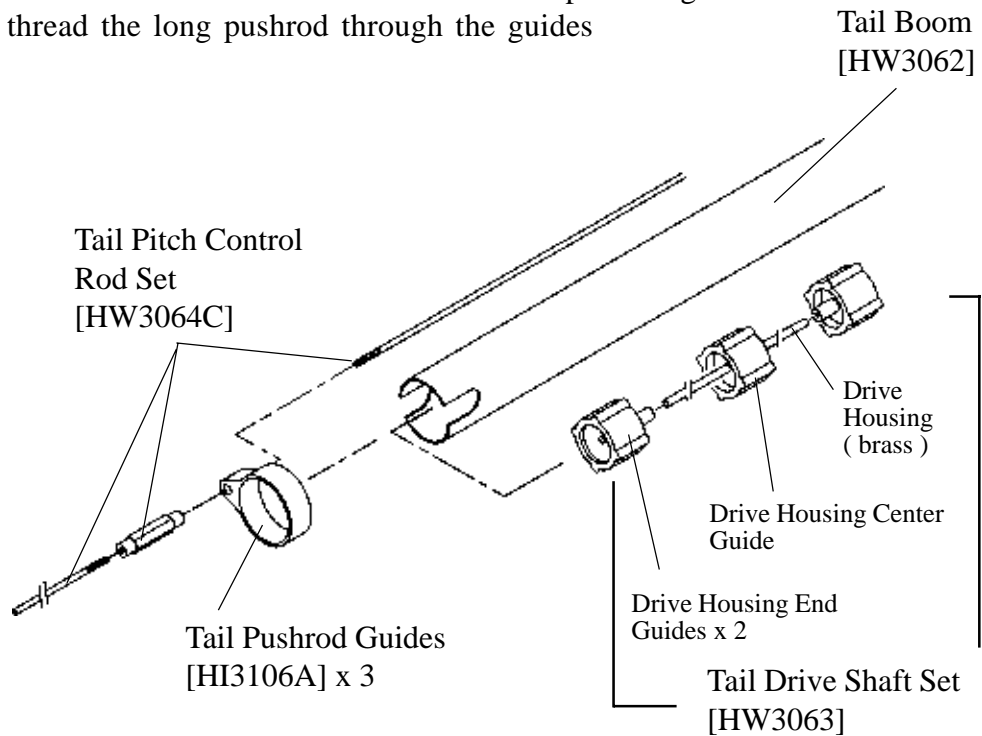

Make sure the brass tubing is glued to the internal guides for the tail boom. Also, after radio set up is complete glue the pushrod guides using a single drop of Zap Ca. One drop will stop the pushrod from binding and still be able to remove them later.

### STEP 34 Tail Drive Shaft

The Tail Drive Shaft has one end flattened to engage into the front of the boom, the other end has been marked for a 3mm flat spot. Using a flat file, grind the flat spot until 1/4 of the material has been removed from the diameter. This will provide solid seating for one of the two 4x4mm Set Screws from the tail rotor input shaft.

Thoroughly grease the tail drive shaft and insert the newly filed end into the end of the tailboom with the slots. Once the shaft exits the tailboom, degrease both ends of the shaft.

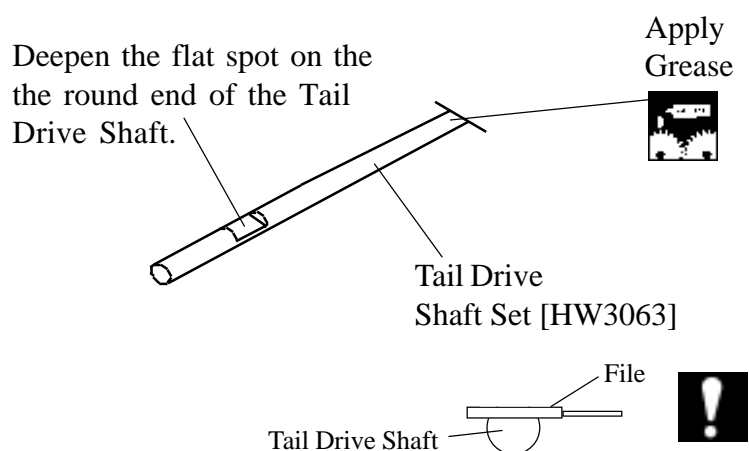

A flat file is the ideal tool for the job, alternately careful use of a Dremel Moto Tool will work. It is important that the flat be at least 1/4 of the diameter but no more than 1/3 to avoid weakening the material.