

## STEP 16 Clutch, Fan & Engine Mounting

From parts bag 3: Remove all parts from the engine crankshaft until you can see the front ball bearing. Install the M9x13 Flat washer (or washer provided by engine manufacturer), insert the Ball Bearings into the clutch bell assembly and place on the crankshaft. Clean the threads on the crankshaft and on the clutch, carefully apply blue threadlock on the last 6mm of crankshaft threads nearest the bearing (be careful not to get threadlock into the ball bearings) and on the threads in the clutch. Thread the clutch onto the crankshaft until the crankshaft can be seen through the top. Insert the fan, keying it to the clutch. Wrap a cloth over the fan (provides grip to the fan without breaking the fins) and tighten until the clutch stops, torque an additional 1/16 of a turn. [CN2155 Optional Parts] makes this easier. Secure the fan with the M6.5x13 Washer and the engine prop nut onto the crankshaft. **Apply some high strength red threadlock to the prop nut to insure its security** Again only torque the nut 1/16th of a turn more.

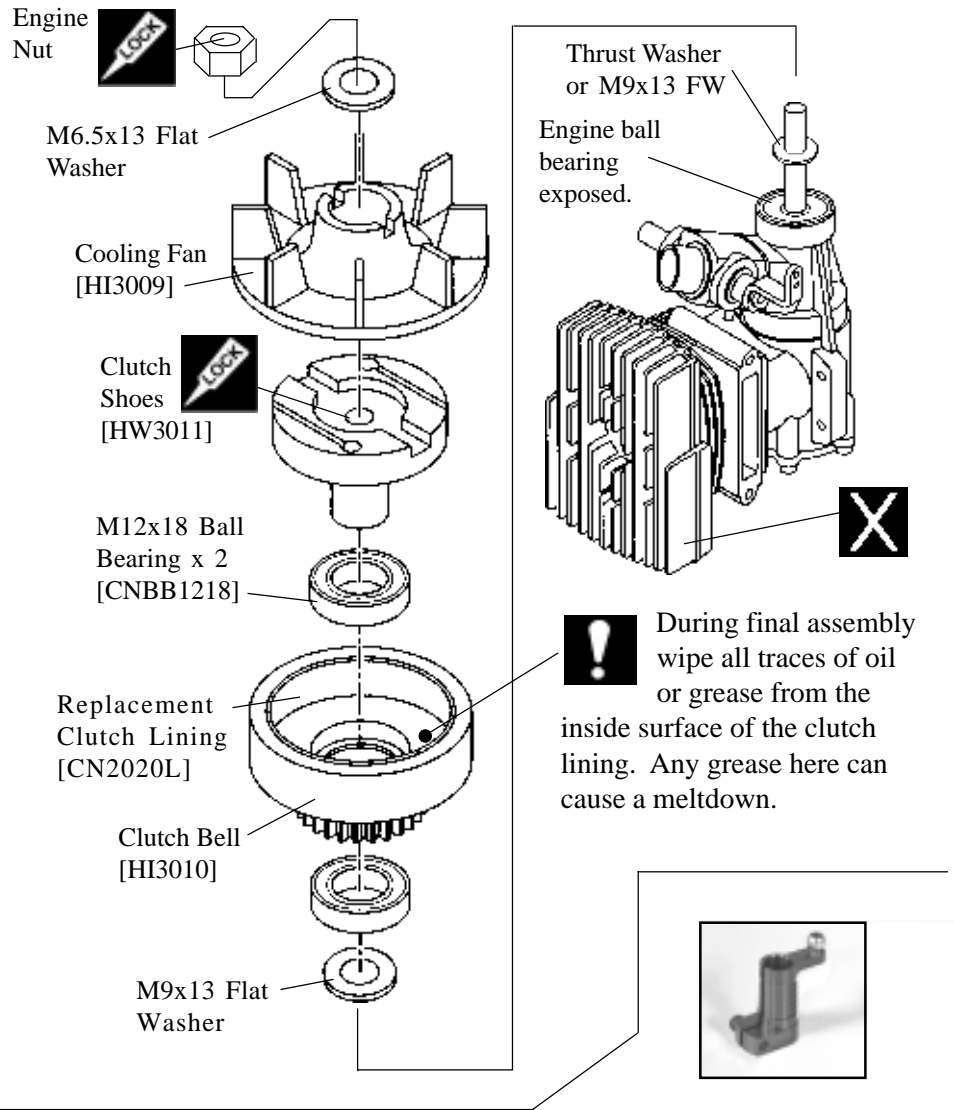

## STEP 17 Engine Mount

Using threadlock, secure the engine assembly onto the engine mount using four 3x16mm Socket Cap Screws. From bag 4, install the Throttle Extension by removing the arm supplied on the engine. The arm has to be repositioned to get equal throw, both open and closed from 50% as per the diagram below.

