

## STEP 13 Upper Side Frames

From parts bag 2: Install two M4x5 Set Screws (*note-do not apply loctite at this time*) into the Mast Stopper (**note that the raised inner diameter must face the ball bearing**) and slide the mast stopper on the main shaft followed by one M10x19 Ball Bearing and one M14x19 Spacer (**the spacer must be installed on top of the bearing**). Slide one M8x19 Ball Bearing from the bottom of the main shaft.

Attach the starter shaft assembly to the left side upper side frame with four M3x12 Self Tapping Screws (*Tip 2- observe the correct orientation of the block assemblies*). Position the main gear/main shaft assembly, (**note the orientation of the mast stopper, the raised inner diameter should be facing upward, towards the inner race of the top bearing**) the counter gear assembly and the tail transmission output shaft assembly in their designated locations (see diagram below) on the upper right side frame (**make sure the bearings are fully seated in the recesses**).

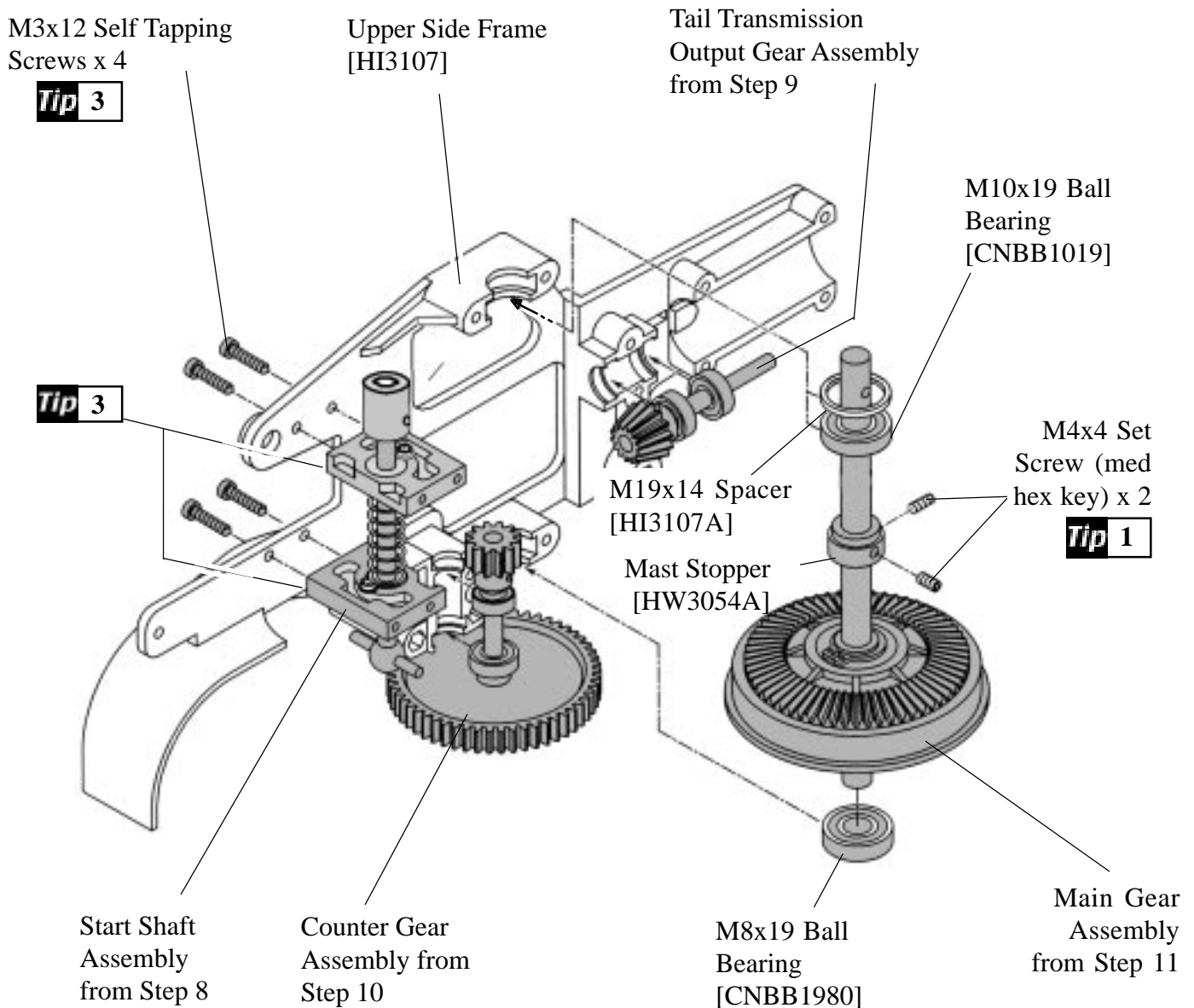

**Tip 3** Be careful when tightening the eight 3x12mm self tapping screws into the start shaft block assemblies as excessive force can strip the plastic holes.